





**OPTIONS**

Live PTO Type: 0 / Ratio: 0.887/1 / Flange SAE B

Clutchable PTO Type: 1 for one output / Electrical valve control 24V / Ratio: 0.679/1- 0.83/1- 0.981/1

Clutchable PTO Type: 2 for two outputs / Electrical valve control 24V / Ratio: 0.619/1- 0.717/1- 0.916/1

Hydraulic pump adaptation flange and couplng, not machined for type 182 (to be machined by customer)

**DIMENSIONS AND WEIGHT (mm/kg)**

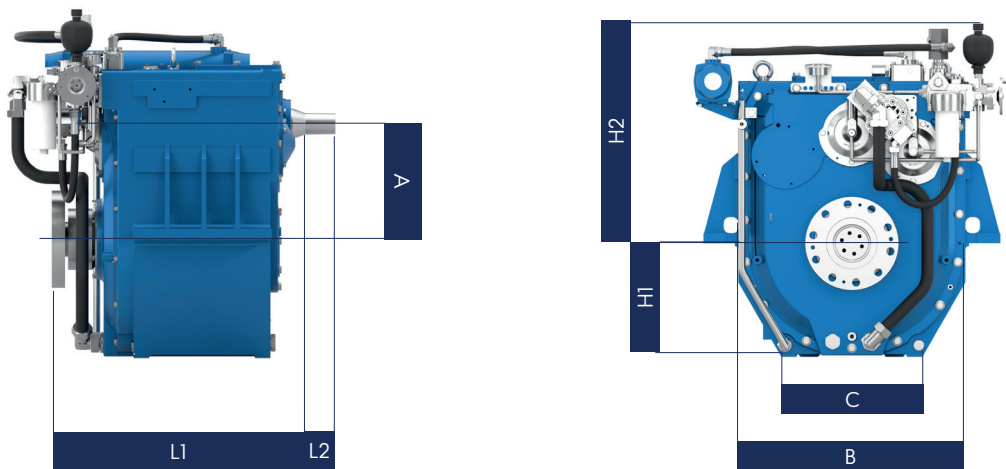

Model	Bell housing	A	B	C	H1	H2	L1	L2	L3	Dry Weight kg(lb)
X37	#1	379	806	484	390	746	864	90	933	1260 (2780)

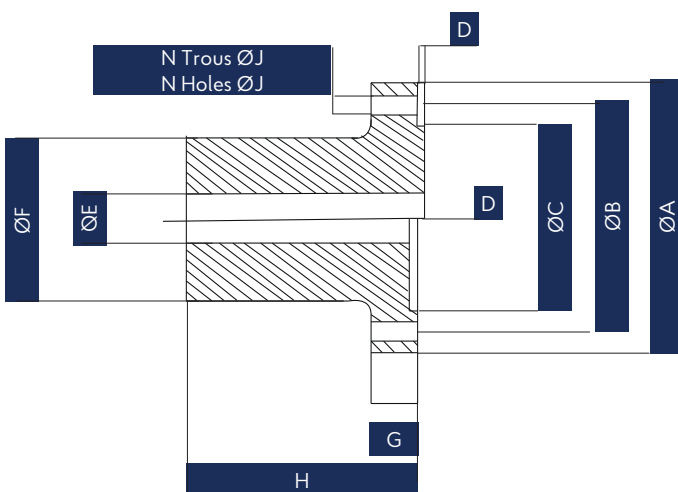

Flange Coupling Dimension												
Type	ØA	ØB +0.15 / -0.15	ØC	D	ØE	ØF	G	H	J	N	Ømaxi forage Ømaxi drilling	CENTRAGE CENTERING
X37	320	270	175	6	50	220	42	255	27.5	10	140	Male

